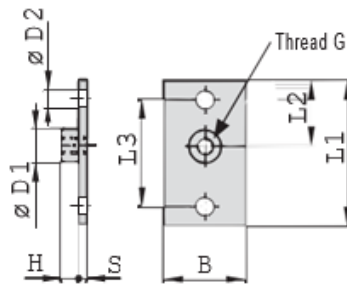
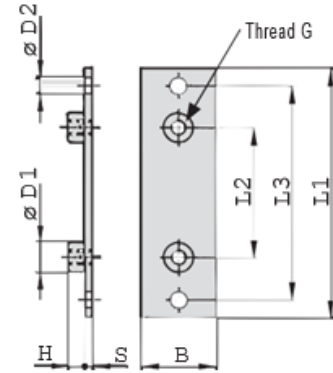

**ELONGATED WELD PLATE (FOR STANDARD SERIES)**
**Type SPV**

**Group 1**

**Group 1A to 8**

Series	Order Code	Elongated Weld Plate						
		L1	L2	L3	B	S	H	D
1	SPV-1-M-W2	58	24.5	44	30	3	6.5	12
1A	SPV-1A-M-W2	64	20	50	30	3	6.5	12
2	SPV-2-M-W2	70	26	56	30	3	6.5	12
3	SPV-3-M-W2	78	33	64	30	3	6.5	12
4	SPV-4-M-W2	87	40	73	30	3	6.5	12
5	SPV-5-M-W2	100	52	86	30	3	6.5	12
6	SPV-6-M-W2	115	66	100	30	3	6.5	12
7	SPV-7-M-W2	150	94	136	30	5	6.5	12
8	SPV-8-M-W2	178	120	162	30	5	6.5	12